



Series 625 DIP Headers with Screw Machine Contacts

FEATURES:

- Aries offers a full line of DIP headers, available with either screw machine or coined contacts in a variety of styles.
- Consult Data Sheet No. 12032 for coined contacts.

SPECIFICATIONS:

- Body material is black UL 94-HB Glass-filled Nylon. Hi-Temp body material is black UL94V-0 4/6 Nylon.
- Fork and Post style contacts are Brass Alloy 360 1/2 hard per UNS C36000 ASTM-B16-85.
- Solder cup style contact is Phosphor Bronze Alloy per 544 UNS C5400 ASTM-B139-90.
- Contact plating is either 200 μ [5.08 μ m] min. 93/7 Tin/Lead per MIL-P-81728 or 10 μ [.25 μ m] min. Gold per MIL-G-45204 over 100 μ [2.54 μ m] min. Nickel per QQ-N-290.
- Contact current rating=2 Amps (3 Amps for Pin Style 5).
- Operating temperature=221°F [105°C] Tin plating, =257°F [125°C] Gold plating.
- Fork contact accepts up to .035 [.89] diameter leads.

MOUNTING CONSIDERATIONS:

- Suggested PCB hole size=.028 \pm .002 [.71 \pm .05] dia.

ALL DIMENSIONS: INCHES [MILLIMETERS]

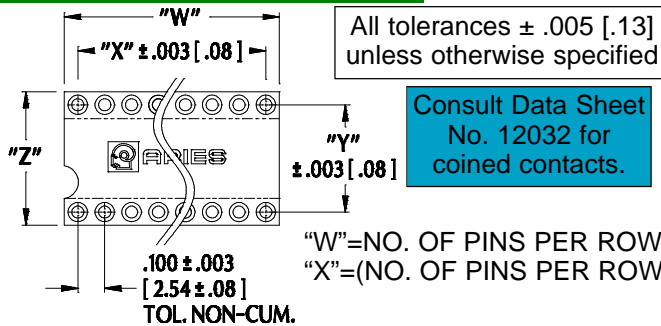

Centers "Y"	Dim. "Z"	Body Style	Available Sizes
.200 [5.08]	.300 [7.62]	A*	2 thru 10
.300 [7.62]	.400 [10.16]	C	2 thru 20
		B	22 thru 40
.400 [10.16]	.500 [12.70]	C	2 thru 22
.600 [15.24]	.700 [17.78]	C	2 thru 40
		B	42 thru 48
.900 [22.86]	1.000 [25.40]	B	2 thru 64

*Note: Reduced tail length for Body Style A

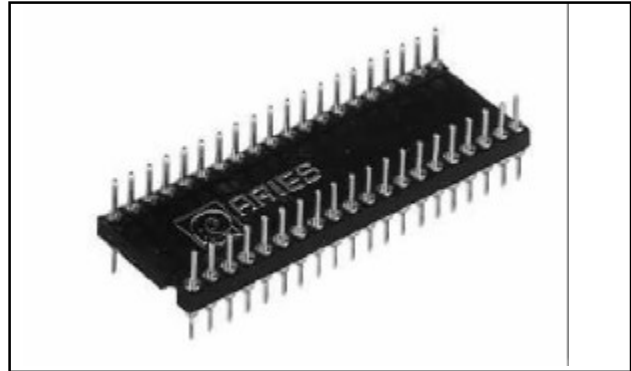
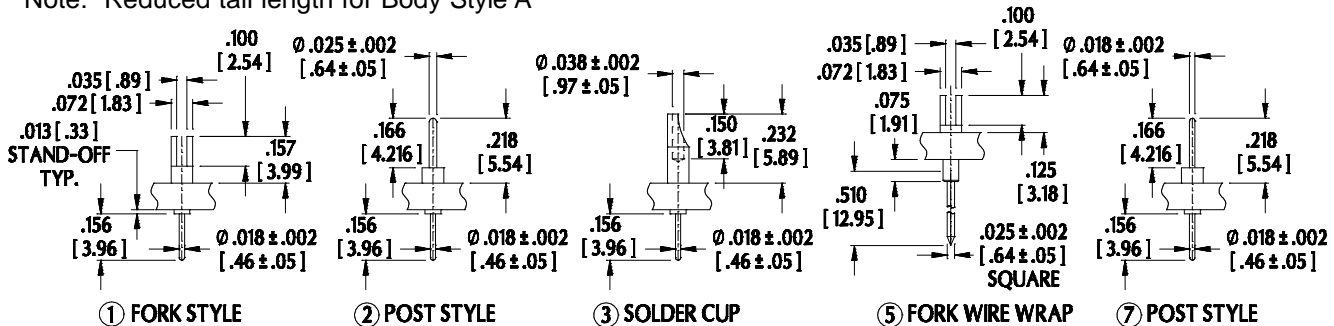

Note: Aries specializes in custom design and production. In addition to the standard products shown on this page, special materials, platings, sizes, and configurations can be furnished, depending on quantities. Aries reserves the right to change product specifications without notice.

ORDERING INFORMATION

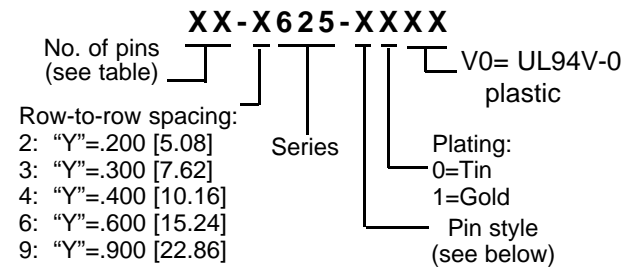

- Row-to-row spacing:
- "Y"=.200 [5.08]
 - "Y"=.300 [7.62]
 - "Y"=.400 [10.16]
 - "Y"=.600 [15.24]
 - "Y"=.900 [22.86]

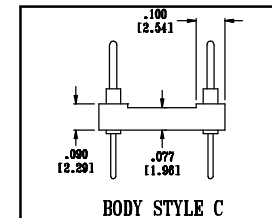
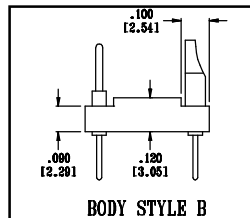
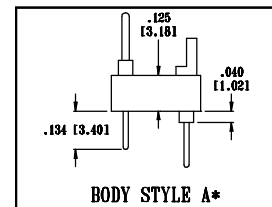

ARIES
ELECTRONICS, INC.
http://www.arieselec.com • info@arieselec.com

NORTH AMERICA
Frenchtown, NJ USA
TEL: (908) 996-6841
FAX: (908) 996-3891



EUROPE
TEL: +44 870 240 0249
FAX: +44 871 919 6033
europe@arieselec.com

12035
REV.C